

Tous droits strictement reserves. Reproduction ou communication a des tiers interdite sous quelque forme que ce soit sans autorisation ecrite du proprietaire. Propriete de c FCI. Droits de reproduction FCI.

All rights strictly reserved. Reproduction or issue to third parties in any form whatever is not permitted without written authority from the proprietor. Property of FCI. Copyright FCI.

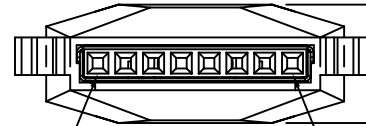

PRODUCT NUMBER
SEE SHT. 2

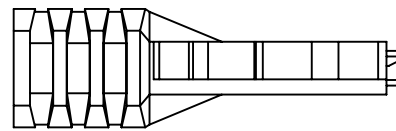
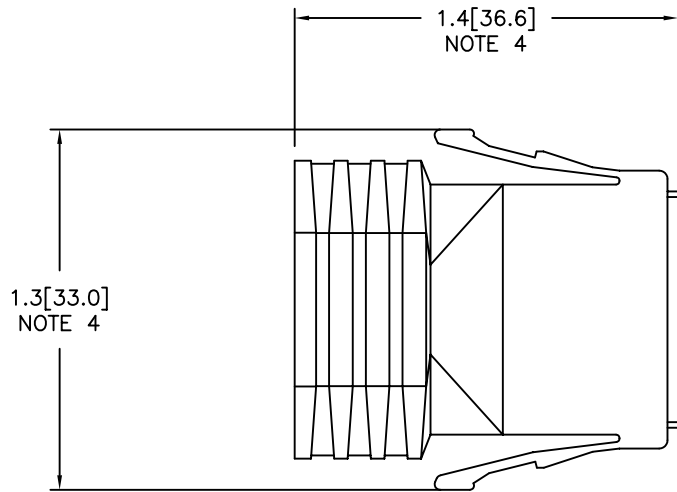

.43 [10.9]
NOTE 4

| | | | | | | | | | | | | |
|-------------|----------------|-----|----------|---------------------------------------|-----------------------|----------|---|---------------|--------|-------------------------------|---|--|
| mat'l. code | | | | tolerances unless otherwise specified | | | | CUSTOMER COPY | | www.fciconnect.com | | |
| ltr | ecn no | dr | date | linear | .XX ±.01/.X±.3 | | projection | INCH/MM | | title | | |
| C | 91512 | CGC | 8/10/99 | | .XXX ±.005/.XX±.13 | | | | | 1X8 LATCH-N-LOK 360° SHIELDED | | |
| D | V91916 | RGD | 10/7/99 | | .XXX ±.0020/.XXX±.051 | | | | | PLUG CONN. KIT W/O PV'S | | |
| E | V92065 | RGD | 10/29/99 | angles | 0° ±2' | | product family LATCH-N-LOK size dwg no | | code | | | |
| F | V01017 | TFG | 5/15/00 | dr | M.HERNANDEZ | 12/03/04 | | | A | | - | |
| G | V01050 | TFG | 6/5/00 | engr | M.BARRIOS | 12/03/04 | | | scale | | - | |
| H | V01093 | TFG | 7/6/00 | chr | M.BARRIOS | 12/03/04 | 1:1 | | 74903 | | | |
| J | M04-0229 | MHT | 12/03/04 | appd | M.BARRIOS | 12/03/04 | | | sheet | | | |
| sheet index | revision sheet | J | J | H | | | | | 1 of 3 | | | |

1 | 2

3 |

4

ACAD

PDM: Rev:J

STATUS: Released

cage code
22526

Printed: Jan 07, 2005

74903-TUVLF

| | |
|----|-------------|
| U | COLOR |
| 01 | LT GRAY |
| 02 | OFF WHITE |
| 03 | DK. GRAY |
| 04 | BLACK |
| 05 | SLATE GRAY |
| 07 | SILVER GRAY |
| 08 | PEARL WHITE |
| 09 | PEBBLE GRAY |

| | |
|---|-----------|
| T | HOLE DIA. |
| 7 | .265/6.73 |
| 9 | .312/7.92 |

EXAMPLE

74903-707LF: IS A 1x8 REAR EXIT PLUG
 IN SILVER GRAY WITH A CABLE EXIT
 HOLE SIZE OF .265 [6.73] CABLE RANGE ,

Tous droits strictement reserves. Reproduction ou communication a des tiers interdite sous quelque forme que ce soit sans autorisation ecrite du proprietaire. Propriete de c FCI. Droits de reproduction FCI.



All rights strictly reserved. Reproduction or issue to third parties in any form whatever is not permitted without written authority from the proprietor. Property of FCI. Copyright FCI.

| | | | | | | | | | | | |
|-------------|----------------|----|------|---------------------------------------|------------------------|----------|-------------|---|-------|------------------------|--|
| mat'l. code | | | | tolerances unless otherwise specified | | | | CUSTOMER COPY | | www.fciconnect.com | |
| ltr | ecn no | dr | date | linear | .XX ±.01/.X±.3 | | projection | title 1X8 LATCH-N-LOK 360° SHIELDED PLUG CONN. KIT W/O PV'S | | | |
| J | | | | | .XXX ±.005/.XX±.13 | | | | | | |
| | | | | | .XXXX ±.0020/.XXX±.051 | | | | | | |
| | | | | angles | 0° ±2° | | INCH/MM | product family LATCH-N-LOK | | code | |
| | | | | dr | M.HERNANDEZ | 12/03/04 | | size | | dwg no | |
| | | | | enr | M.BARRIOS | 12/03/04 | | A | | 74903 | |
| | | | | chr | M.BARRIOS | 12/03/04 | scale | | sheet | | |
| | | | | appd | M.BARRIOS | 12/03/04 | 1:1 | | 2 of | | |
| sheet index | revision sheet | | | | | | | | | | |

Tous droits strictement réservés. Reproduction ou communication a des tiers interdite sous quelque forme que ce soit sans autorisation écrite du propriétaire. Propriété de c FCI. Droits de reproduction FCI.

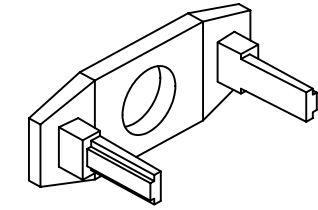

REAR CAP

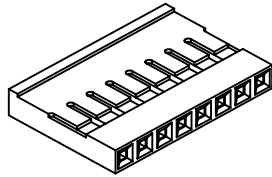

MINI LATCH HOUSING

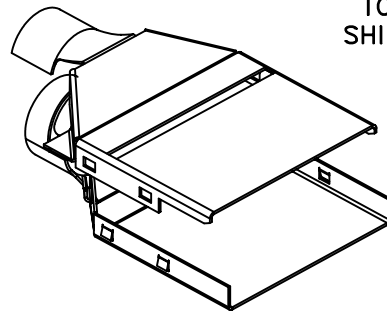

TOP SHIELD

BOTTOM SHIELD

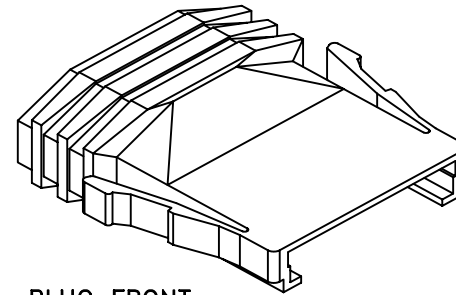

PLUG FRONT

NOTES:

- ① EACH KIT CONTAINS ONE EACH OF THE FOLLOWING COMPONENTS
LATCH-N-LOK PLUG
LATCH-N-LOK END CAP
MINI LATCH HOUSING
360° SHIELD CANS.
- 2. COMPONENTS ARE BULK PACKAGED WITH 100 pcs. OF A COMPONENT PER BAG. PVC'S MUST BE ORDERED SEPARATELY.
- 3. MATERIALS USED: PLUGS AND CAPS ARE MOLDED IN POLYCARBONATE. THE MINI LATCH HOUSING ARE MOLDED IN NYLON. COLOR IS BLACK. THE SHIELD CAN IS 3/4 HARD BRASS PLATED WITH 2.5um MIN. BRIGHT TIN. 1.0um MIN. NICKEL UNDERPLATE.
- ④ DIMENSIONS ARE APPROXIMATE AND REFLECT PLUG IN UNLATCHED STATE.
- 5. PART NUMBERS WITH LF IN THE END ARE LEAD FREE.
- 6. THIS PRODUCT MEETS EUROPEAN UNION DIRECTIVES AND OTHER COUNTRY REGULATION AS DESCRIBED IN GS-22-008.



All rights strictly reserved. Reproduction or issue to third parties in any form whatever is not permitted without written authority from the proprietor. Property of FCI. Copyright FCI.

| | | | | | | | |
|-------------|----------------|----|------|---------------------------------------|-----------------------|---------------|---|
| mat'l. code | | | | tolerances unless otherwise specified | | CUSTOMER COPY | www.fciconnect.com |
| ltr | ecn no | dr | date | linear | .XX ±.01/.X±.3 | | |
| H | | | | | .XXX ±.005/.XX±.13 | scale 1:1 | product family LATCH-N-LOK size 74903 |
| | | | | angles | .XXX ±.0020/.XXX±.051 | | |
| | | | | dr | 0° ±2° | | |
| | | | | enr | M.HERNANDEZ 12/03/04 | | |
| | | | | chr | M.BARRIOS 12/03/04 | | |
| | | | | appd | M.BARRIOS 12/03/04 | | |
| sheet index | revision sheet | | | | | | |